

COOKER HOOD

INSTRUCTION MANUAL

Read this manual carefully before operation

Pictures in this manual are for reference only, the product in kind prevail.

MCH-90B82

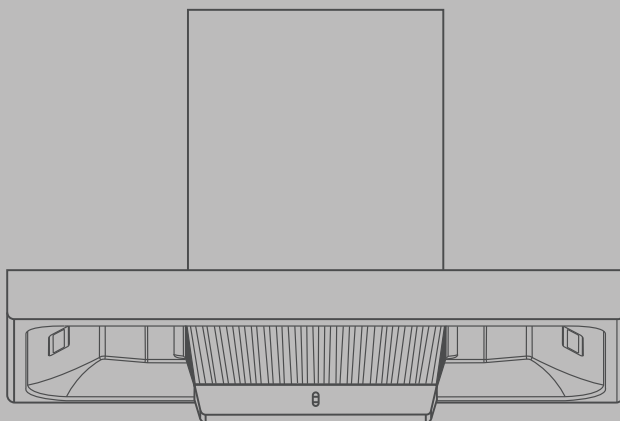

Contents

01 Contents..... 2

02 Warnings..... 3

03 Safety Warning..... 5

04 Installation instruction 6

05 Accessories..... 8

06 First using..... 9

07 Maintenance..... 10

08 Main Parameters..... 12

09 Trouble shooting..... 13

10 Warning notice..... 14

11 Disposal..... 15

- This appliance is not intended for use by persons (including children) with reduced physical, sensory or mental capabilities, or lack of experience and knowledge, unless they have been given supervision or instruction concerning use of the appliance by a person responsible for their safety. Children shall not play with the appliance. Cleaning and user maintenance shall not be made by children without supervision. If the supply cord is damaged, it must be replaced by the manufacturer, its service agent or similarly qualified persons in order to avoid a hazard.
- There shall be adequate ventilation of the room when the range hood is used at the same time as appliances burning gas or other fuels.
- Please do not use corrosive detergent for cleaning. The proper function of the unit is conditioned by the regularity of the maintenance.
- To protect the main body from corrosive of the long time accumulation of dirt, the cooker hood should be cleaned with hot water with non-corrosive detergent every two months.
- There is a fire risk if cleaning is not carried out in accordance with the instructions.
- Do not flame under the range hood.
- The air must not be discharged into a flue that is used for exhausting fumes from appliances burning gas or other fuels.
- The minimum distance between the supporting surface for the cooking vessels on the hob and the lowest part of the range hood (When the range hood is located above a gas appliance ,this distance shall be at least 65cm,If the instructions for instillation for the gas hob specify a greater distance,this has to be taken into account.The distance of 65cm can be reduced for)

Warnings

- Regulations concerning the discharge of air have to be fulfilled.
- The appliance uses 4 hob elements at most.
- **CAUTION:** Accessible parts may become hot when used with cooking appliances.
- **Lamp information**

The air flow parameter is tested under conditions of 230V~/50Hz when the voltage is 220-240V~/50Hz.

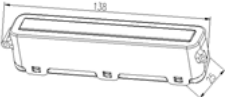
	Max Power	Voltage	Picture	Lamp Cap
Square / Diameter: 25mm x 138mm	1.5W	DC 12 V		---

Safety Warning

This appliance can be used by children aged from 8 years and above and persons with reduced physical, sensory or mental capabilities or lack of experience and knowledge if they have been given supervision or instruction concerning use of the appliance in a safe way and understand the hazards involved. Children shall not play with the appliance. Cleaning and user maintenance.

- The appliance is not intended for use by young children or infirm persons without supervisions.
- Young children should be supervised to ensure they do not play with the appliance.
- Plug the power cord to socket outlet with earthing continuity terminal.
- The cooker hood is for home use only, not suitable for barbecue, roast shop and other commercial purposes.
- The cooker hood and its filter should be cleaned regularly according to the instruction.
- Do not use open flame, or allow oil to go beneath the appliance.
- If there is any fault occurred with the appliance, please call after-sale service department.
- Please keep the kitchen room ventilated.
- Prior to any maintenance, cleaning operation, ensure the power is cut off.
- If the supply cord is damaged, it must be replaced by the manufacturer, service agent or similarly qualified person in order to avoid a hazard. The replaced power cord should be provided by manufacturer or seller.
- If the plug or cord is damaged, please call after-sale service center.
- There is a fire risk if cleaning is not carried out in accordance with the instruction.
- In case of damaged connecting wire, please refer to the manufacturer, after-sale service personnel or other qualified technicians.
- Use the unit according to the instructions to avoid any fire hazard.
- The exhaust air must not be introduced into a smoke flue or chimney that is used for exhausting fumes from appliances burning gas.
- Follow the local laws applicable for external air evacuation.

Installation instruction

Determine location

Range hood should be installed horizontally on the top of the stove, the installation diagram is as follows:

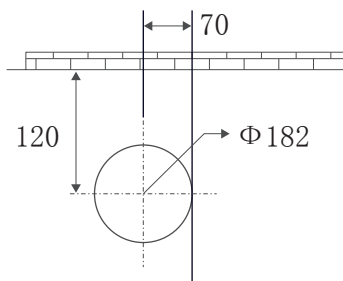
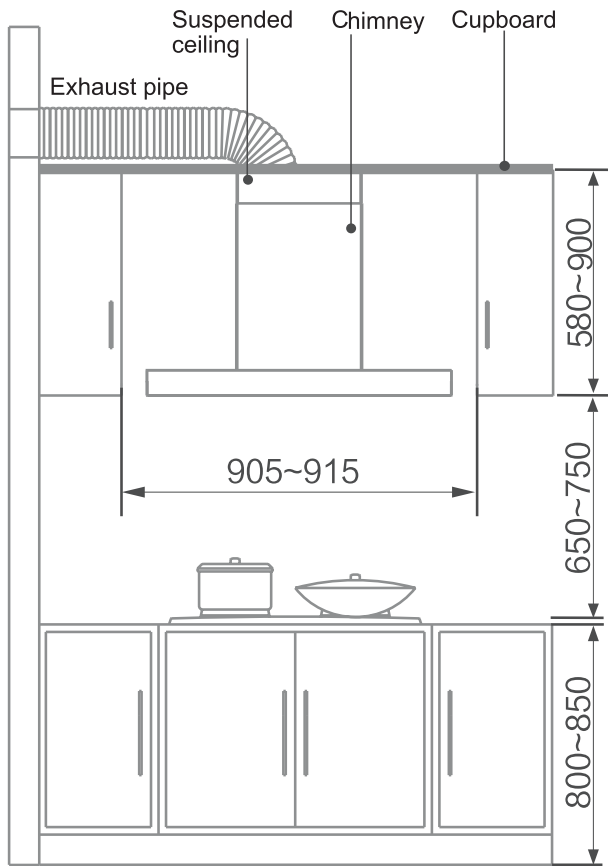

Schematic diagram of the hole size of the exhaust pipe at the ceiling

Installation plate

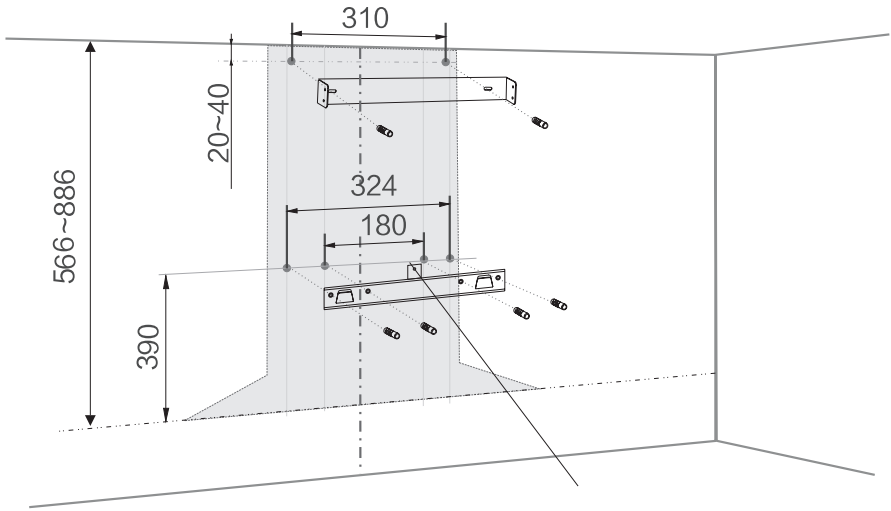

Warning:

Failure to install the screws or fixing device in accordance with these instructions may result in electrical hazards.

Accessories

1

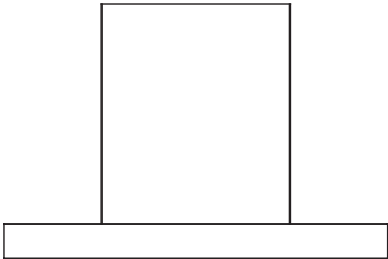

1	Range hood body	1
2	Exhaust pipe	1
3	Installation plate	1
4	Oil cup	1
5	Screws M5*16	1
6	Screw M5*50	6
7	Expansion bolt	6
8	Self tapping screw ST4.2*9.5	2
9	Chimney fixing bracket	1

2

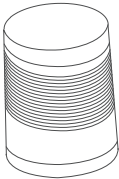

3

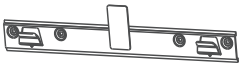

4

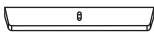

5



6



7



8



9

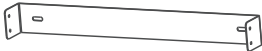

Range hood can be used after power.

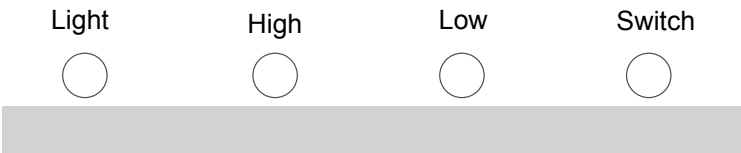

<input type="radio"/>	Light	Press: Turn on the light.
<input type="radio"/>	High speed	Turn on the power; Press Hight speed : Turn on high speed ; Press Low speed : Turn on low speed. (Two patterns can't run at the same time)
<input type="radio"/>	Low speed	
<input type="radio"/>	Switch	1 st Short press: Start up (speed); 2 nd Short press: End (speed).

Daily maintenance

Internal cleaning

- 1 Unplug the power cord, unscrew the screws for fixing cover.

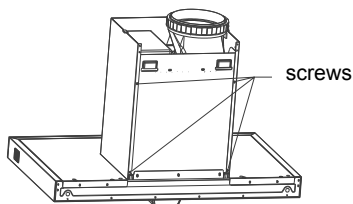

- 2 Remove the decorative cover.

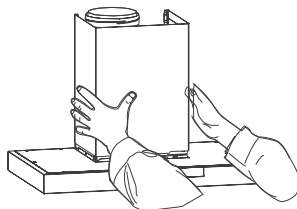

- 3 Remove screw, take down the rack cover plate.

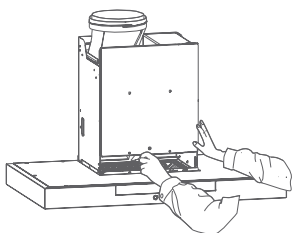

- 4 Remove screw, take down the air inlet ring.

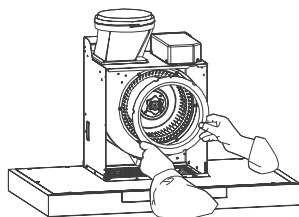

- 5 Loose the nut according to instruction, take out the impeller.

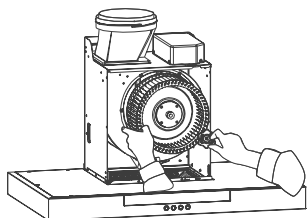

- 6 Clean the impeller and volute with neutral detergent, install them accoring to reverse order of disassembly.



Dismantle the filter to clean the impeller and volute, needs to be completed by professionals.

Surface cleaning

- 1 Recommendation after cooking with a dry cloth or a wet cloth moistened with neutral detergent to clean the inside and outside surfaces of the machine. Do not use clean balls, brushes or coarse cloth to avoid scratching the machine surface.
- 2 Oil cup installation:
The cup holder into the buckle in the air inlet hood, Return the oil cup horizontally with both hands
- 3 Oil cup disassemble:
Hold the oil cup edge with both hands, Move it.
- 4 Suggestion:
Clean the air inlet hood every 2 weeks or no less than every month.
- 5 How to clean:
 1. Unscrew the air inlet hood and take it out.
 2. Put the hood into warm water with neutral detergent.
 3. Clean it with a soft brush.
 4. Mounting it when it's dried.
 5. Install the air inlet hood.

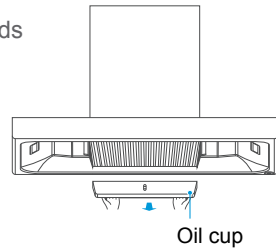

Main Parameters

Voltage	220-240V~/50Hz
Rated Power	223W
Lighting Power	2 X 1.5W
Motor Power	220W
Diameter of air tube	180mm
Noise	≤69dB(A)

Trouble Shooting

Fault	Solution
Both light and motor do not work	Unplug power plug and reconnect the power supply.
Oil leakage	Oil cup tilt, please reinstall.
	Oil cup full filled with oil, please dump the oil.
	Oil-way blockage caused by long time uncleaned internal oil-way, needs professionals to wash the hood.
Insufficient suction	Avoid opening window or door frequently.
	Adjust to max. speed.
Loud noise	Reinstall the exhaust pipe properly
	Ensure firm installation

After service

Product non-artificial breakdown within warranty period from purchase date will be offered free repair service based on invoice. Damage due to improper use, out of warranty and poor maintenance will be repaired by our company but charging certain maintenance cost. Please don't tear off the product bar code so that the repairman can verify the record. Please read the warranty notice concerning other matters.

Warranty notice

First, to safeguard your interests, please fill out the installation service card carefully and retain the receipt for warranty.

Second, the product purchased in our company that has breakdown due to quality problem can be repaired at designated special service department based on valid purchase proof. Free repair is offered within warranty period (from the date of purchase proof issued).

Third, the following situations, we are not responsible for product "Three Guarantees" repair service but still provide charging service:

- 1) The product damaged due to improper use or poor safekeeping.
- 2) The product damaged not caused by installation or maintenance of special service department staff.
- 3) The product without valid purchase proof.
- 4) The product's purchase proof has been altered.
- 5) The product model and body code registered on installation service card is inconsistent with the model and body code of the product to be repaired.
- 6) The product damaged due to the instability of power voltage or exceeding normal voltage scope (198-242) V.a.c, or power circuit installation not meeting the national electrical installation requirement.
- 7) The product sold at discounted price or with "OFF-Grade" and "Substandard Goods" printed on installation service card or the body.
- 8) Product damaged due to irresistible natural disaster.
- 9) Product warranty period is expired.
- 10) The product damaged by the unsuitable and improper method specified in instruction book.

Fourth, if your reasonable service demand can't be solved by special service department or dissatisfaction with their service, please make an immediate call or write a letter to our customer service center, we will provide you with our service.

Disposal



Please dispose of it at your local community waste collection / recycling center and ensure it presents no danger to children while being stored for disposal. The plug must be rendered useless and the cable cut off to prevent misuse.

The manufacturer shall decline all responsibility if the foregoing recommendations and instruction regarding installation, maintenance and use are not observed and respected when using the cooker hood.